



# **Penguicon 2010 Facilities Layout**

Troy Marriott  
r100415.01

# Table of Contents





Overview	3
Exterior	4
Athens	5
Ballroom Overview	6
Ballrooms A – D	7
Ballroom E	8
Ballroom F	13
Ballroom G	14
Ballroom H	15
Boardroom	16
Lobby	17
Dennison I	18
Dennisons II, III, and IV	19
Dennison Hallway	20
Mediterranean	21
Niles	22
Perfect Season	23
Private Dining 1	24
Private Dining 2	25
Guest Rooms & Parking Garage	26

# Overview

## Equipment Overhead (max simultaneous use):

Tables (6x30):	43
Tables (6x18):	54
Tables (8x30):	14
Tables (8x18):	5
Tables (5' 6" Round):	13
Table skirting:	87
Table round skirting:	13
Chairs:	1273
Stage sections (4' x 6')	12
Stage steps:	5
Roll-off beds:	2
Telephone Drops:	1

### Symbols:

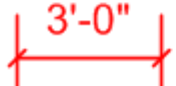
- 
Chair
- 
Trash Can
- 
Make sure there is power
- 
Outlet (110)
- 
Measurement for furniture placement
- 
Room measurement

# Exterior

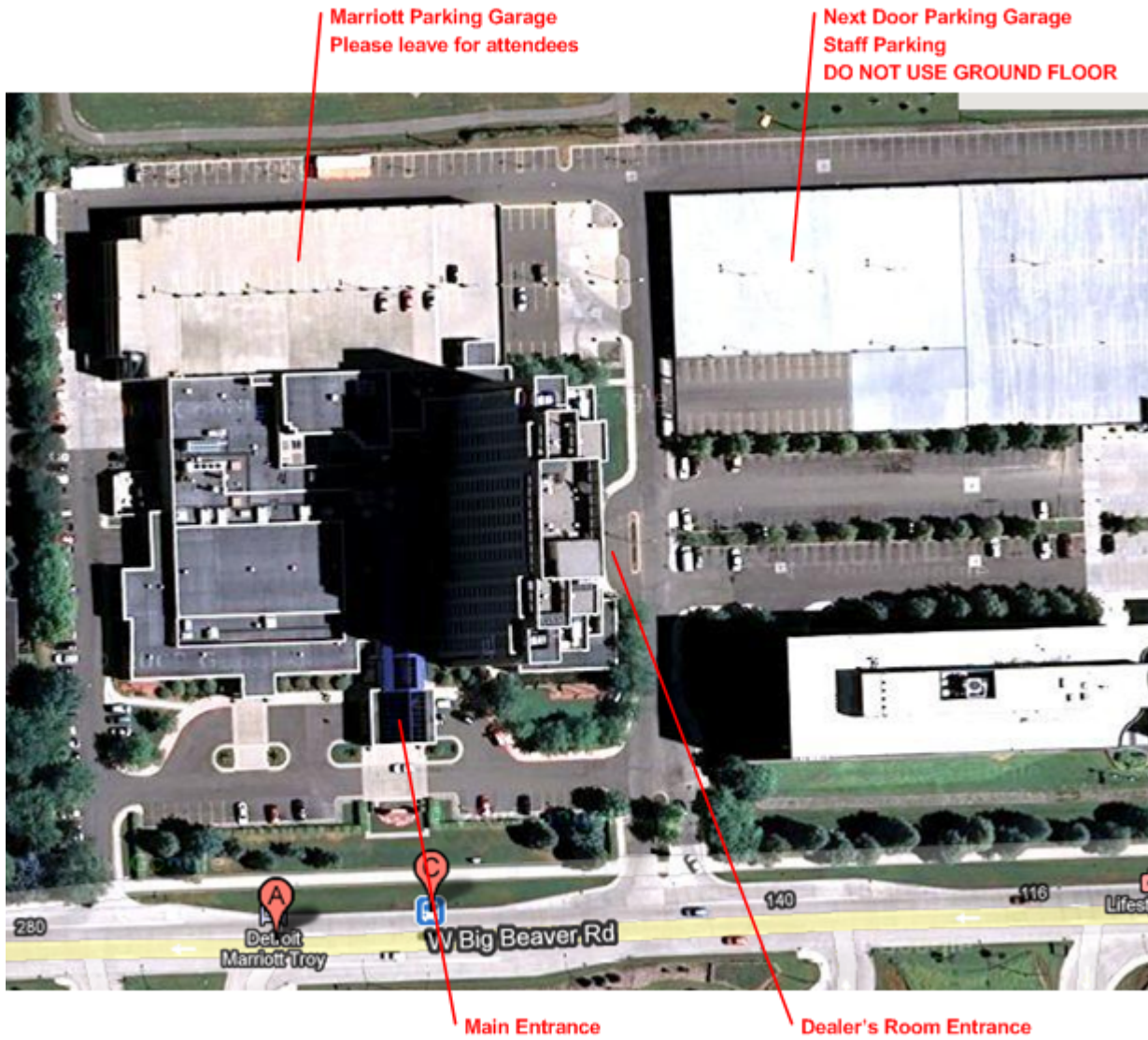

**Room:** Athens  
**Use:** Computer Lounge

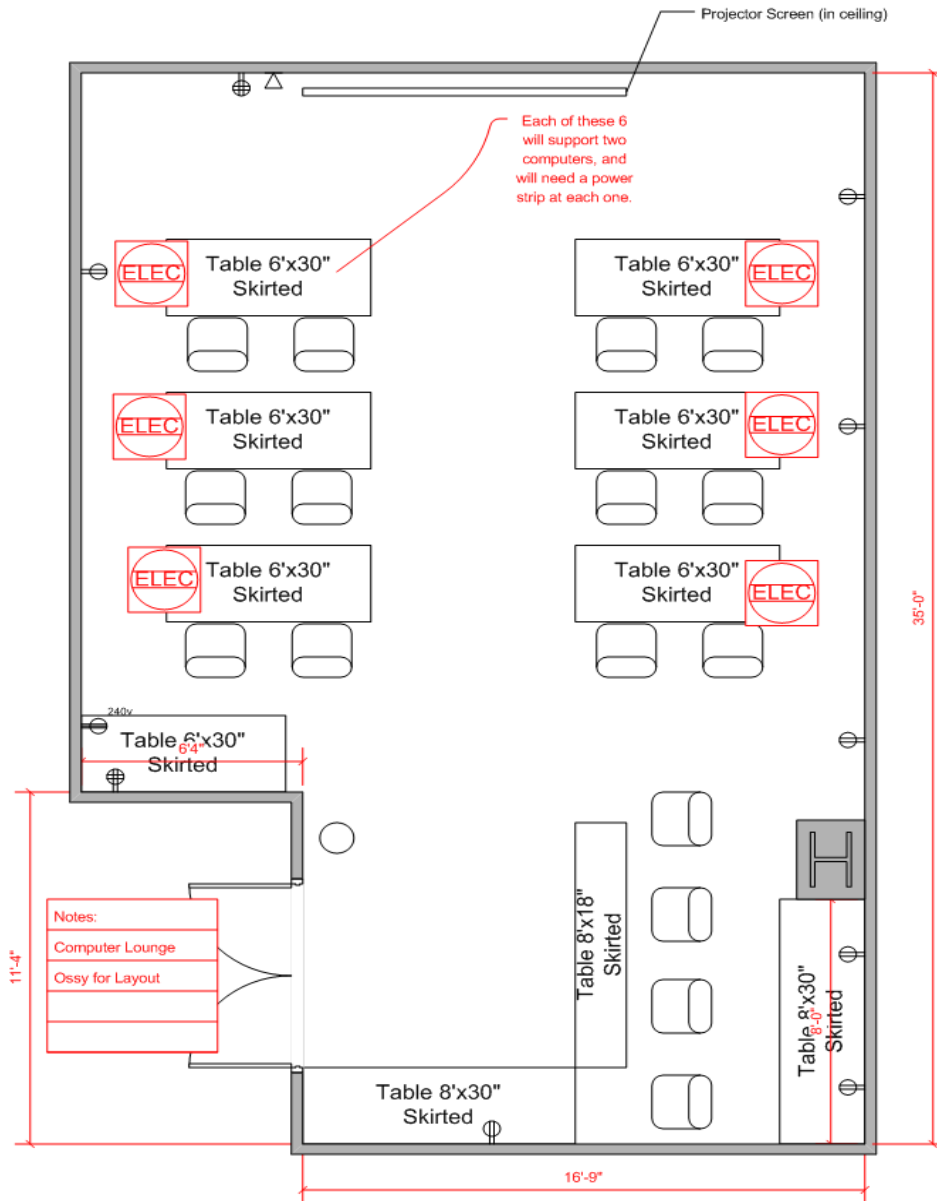

**Equipment:**

- 7 – Tables (6' x 30")
- 2 – Tables (8' x 30")
- 1 – Tables (8' x 18")
- 10 – Skirting
- 16 – Chairs

**Notes:**

Power to classroom-style tables

**Room:** Ballrooms A through H  
**Use:** Panels, Bigtop, Dance, etc

Ballrooms

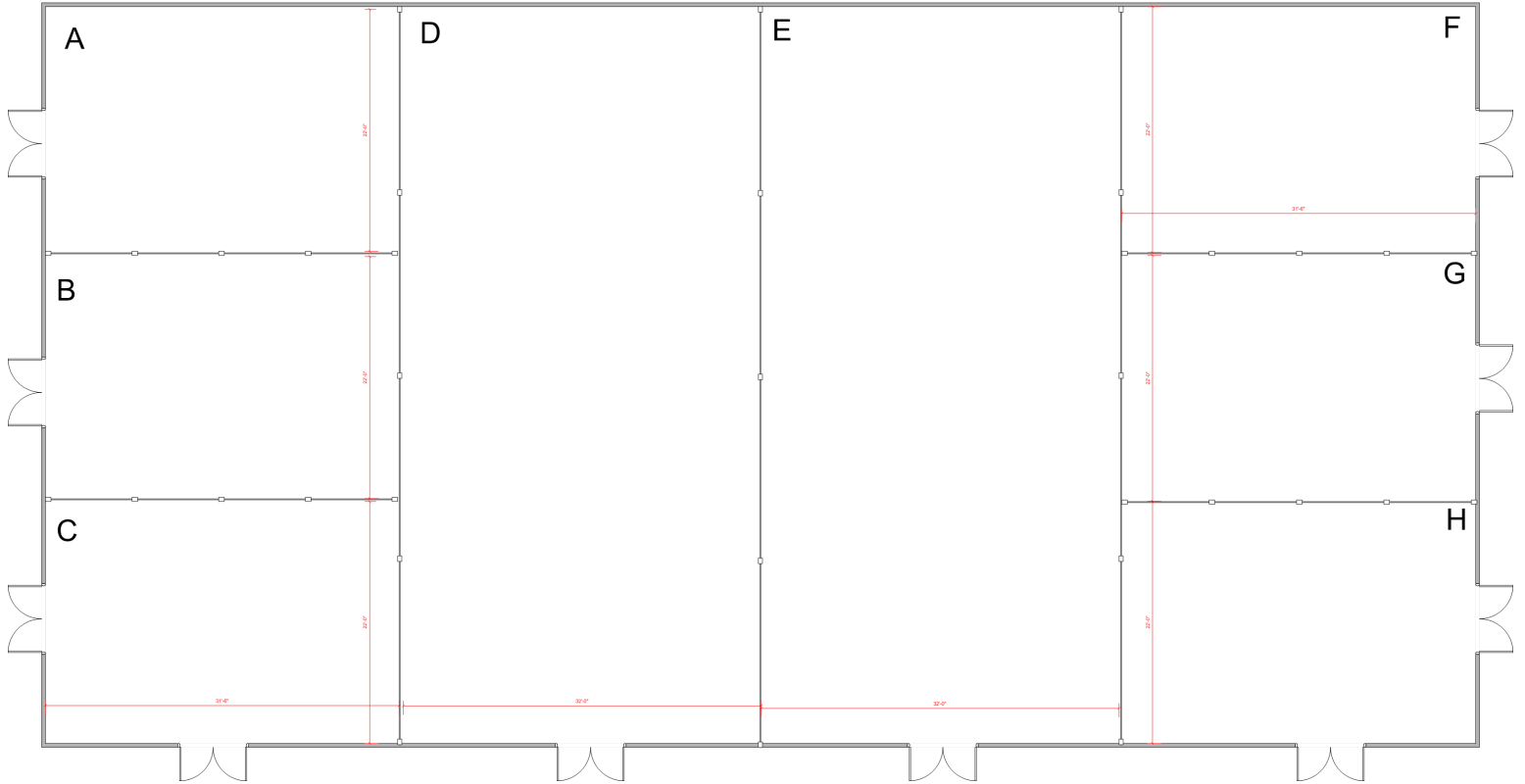

**Notes:**

This is detailed on later pages...

**Room:** Ballrooms A-D

**Use:** Bigtop (Masquerade, Drag Show, Opening Ceremonies, etc)

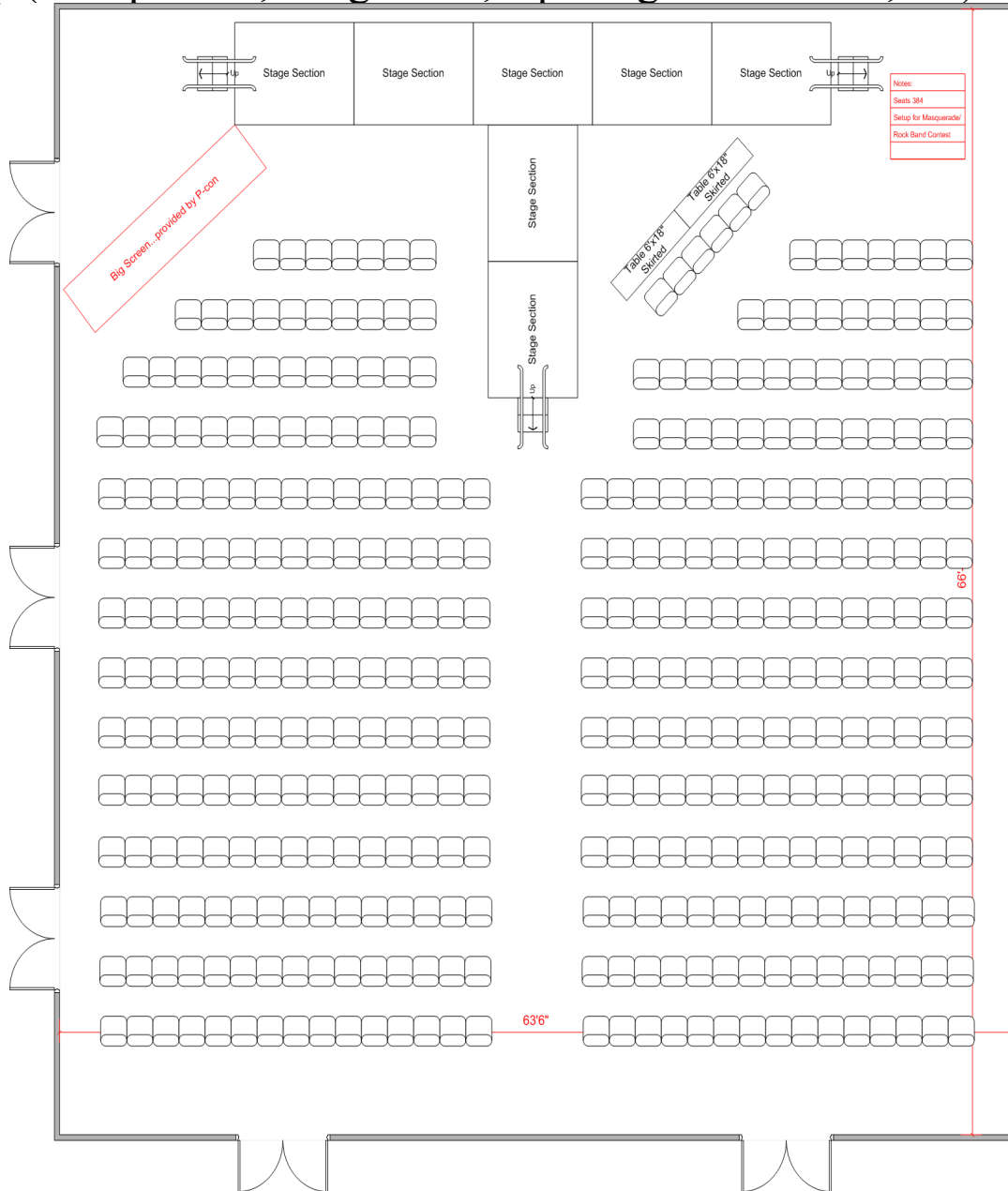

**Equipment:**

- 7 – Stage Sections
- ~400 – Chairs
- 2 – Tables (6' x 18")
- 3 – Stage steps
- 2 – Skirting

**Notes:**

Projector/Screen provided by Penguicon  
 Water service outside main hallway doors (bottom of drawing)

**Room:** Ballroom E (Friday 1500 to Saturday 1700)  
**Use:** Large Panels

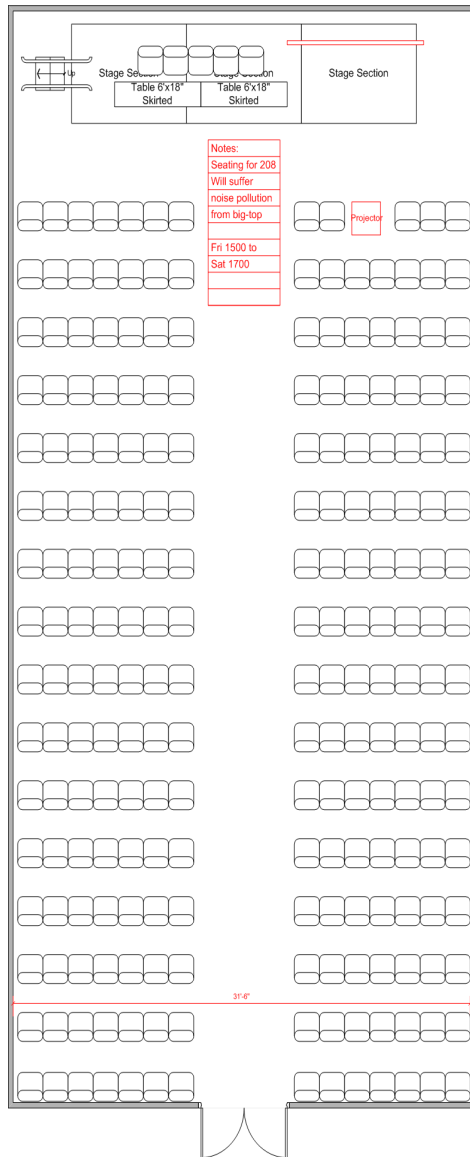

**Equipment:**

- 2 – Tables (6' x 18")
- ~210 – Chairs
- 3 – Stage sections
- 1 – Stage steps
- 2 – Skirting
- Dance floor

**Notes:**

Projector/Screen provided by Penguicon



**Room:** Ballroom E (Saturday 1730 to Sunday 0600)  
**Use:** Dance

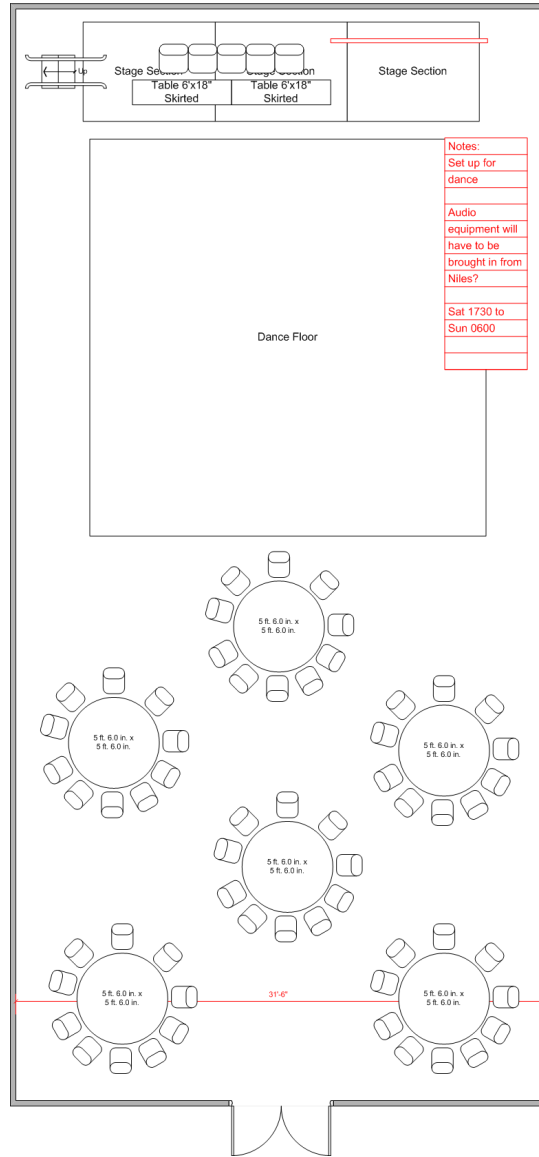

**Equipment:**

- 2 – Tables (6' x 18")
- 6 – Tables (5.5' round)
- ~65 – Chairs
- 3 – Stage sections
- 1 – Stage steps
- 8 – Skirting
- Dance floor

**Notes:**

Projector/Screen provided by Penguinicon

**Room:** Ballroom E (Sunday 0800 to Sunday 1300)

**Use:** Junkpile Wars

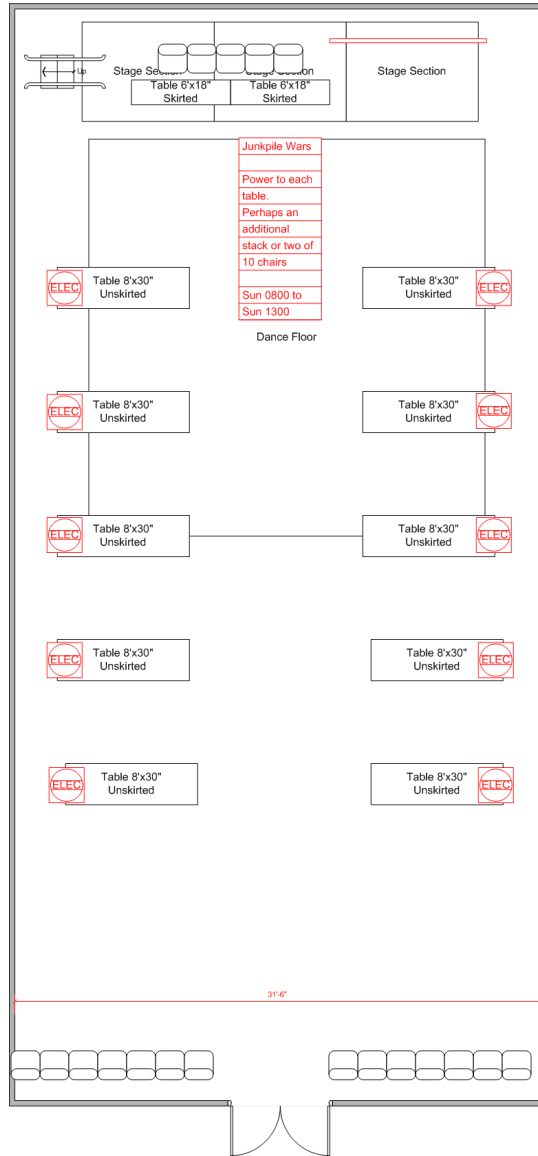

**Equipment:**

- 2 – Tables (6' x 18")
- 10 – Tables (8' x 30")
- ~19 – Chairs
- 3 – Stage sections
- 1 – Stage steps
- 2 – Skirting
- Dance floor

**Notes:**

Projector/Screen provided by Penguinicon

**Room:** Ballroom E (Saturday 1730 to Sunday 0600)

**Use:** Dance

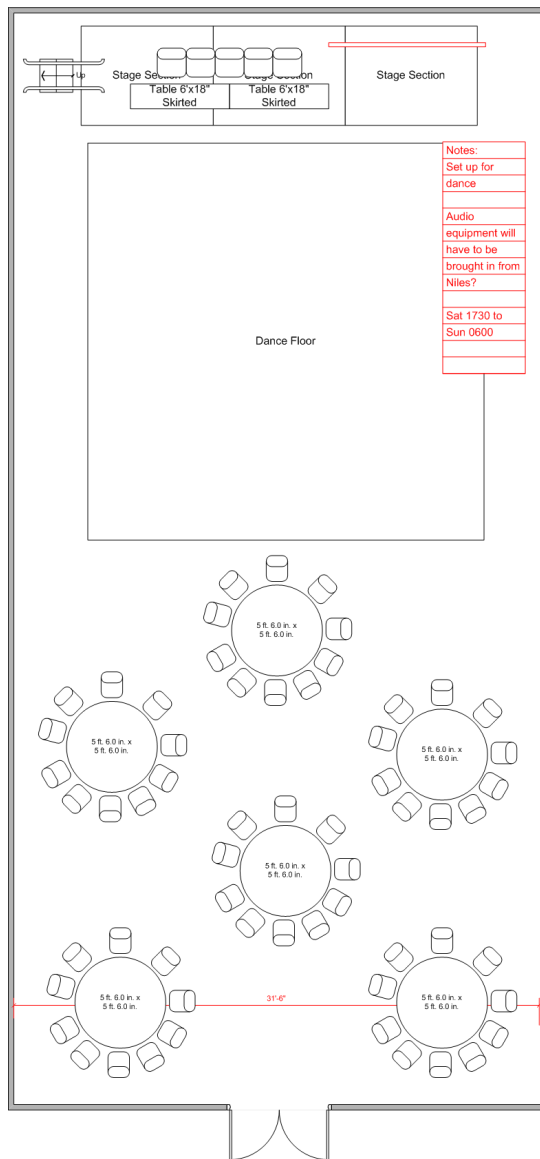

**Equipment:**

- 2 – Tables (6' x 18")
- 6 – Tables (5.5' round)
- ~65 – Chairs
- 3 – Stage sections
- 1 – Stage steps
- 8 – Skirting
- Dance floor

**Notes:**

Projector/Screen provided by Penguicon

**Room:** Ballroom E (Sunday 1300 to Sunday 1500)

**Use:** Large Panels

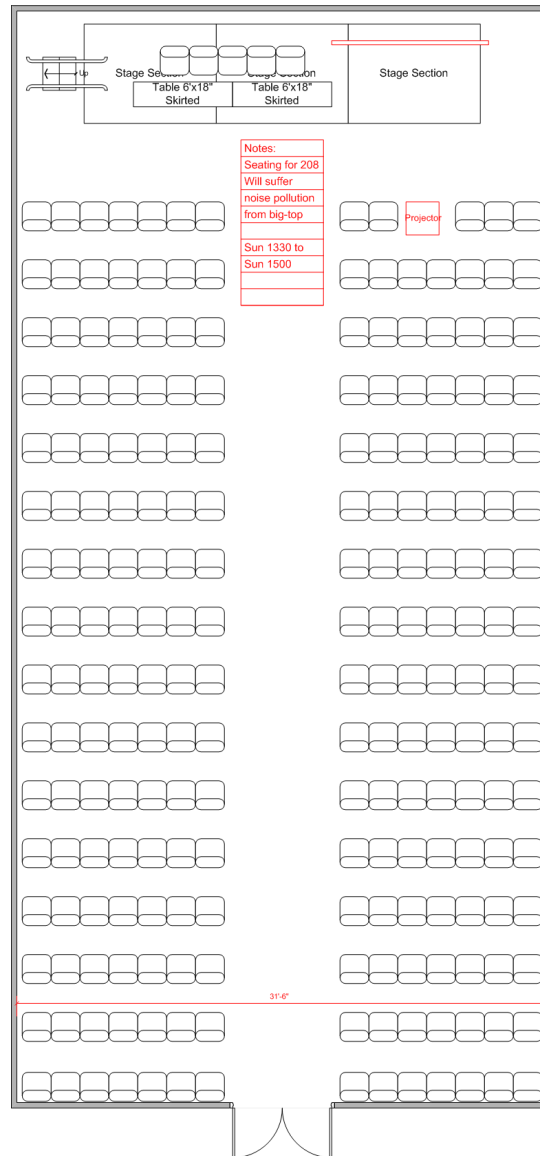

**Equipment:**

- 2 – Tables (6' x 18")
- ~210 – Chairs
- 3 – Stage sections
- 1 – Stage steps
- 2 – Skirting
- Dance floor

**Notes:**

Projector/Screen provided by Penguicon

**Room:** Ballroom F  
**Use:** Medium Panels

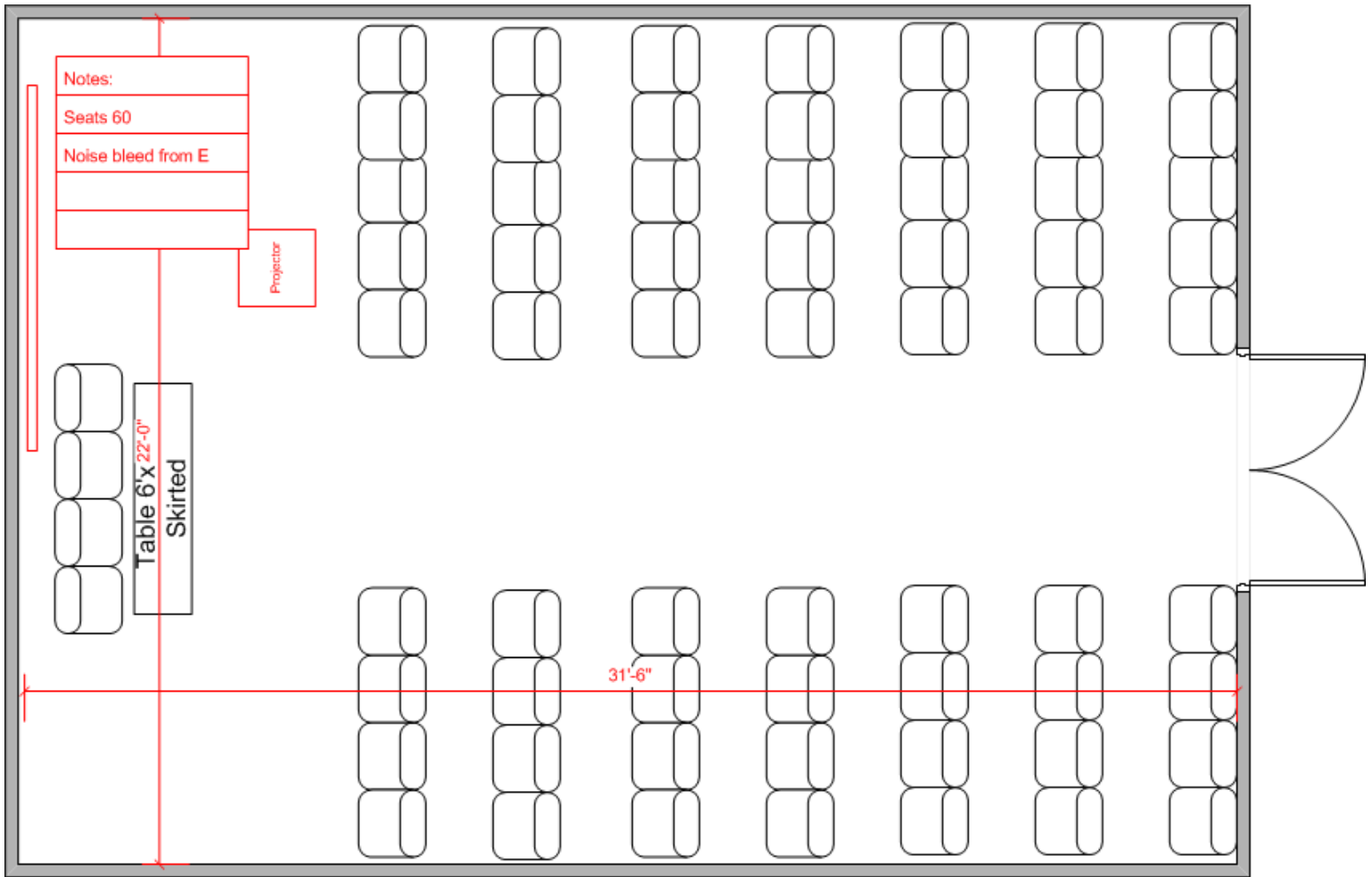

**Equipment:**

- 1 – Table (6' x 18")
- ~65 – Chairs
- 1 – Skirting

**Notes:**

Projector/Screen provided by Penguinicon

**Room:** Ballroom G

**Use:** Medium Panels

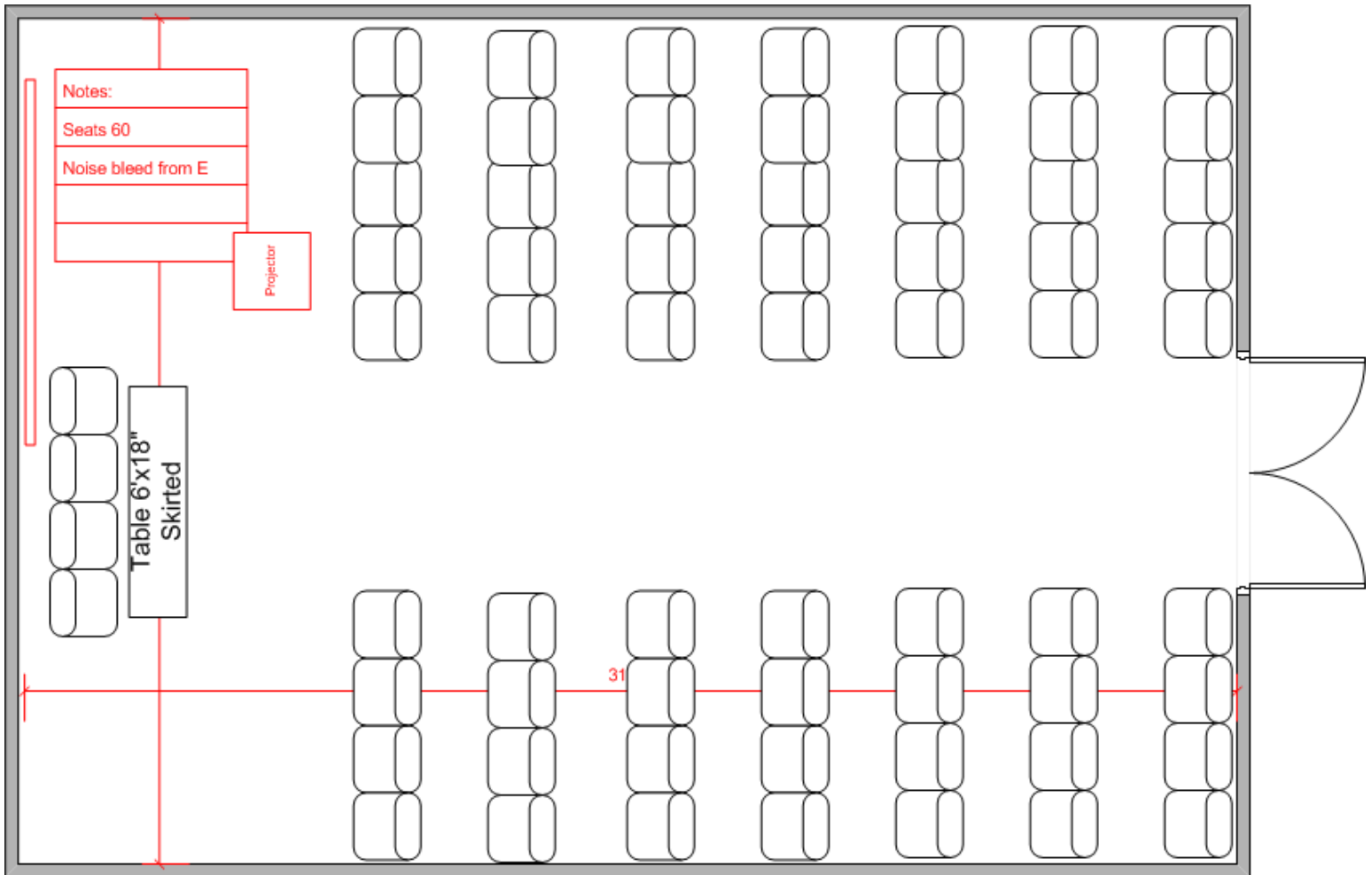

**Equipment:**

1 – Table (6' x 18")

~65 – Chairs

1 – Skirting

**Notes:**

Projector/Screen provided by Penguicon

Water service outside door

**Room:** Ballroom H  
**Use:** Medium Panels

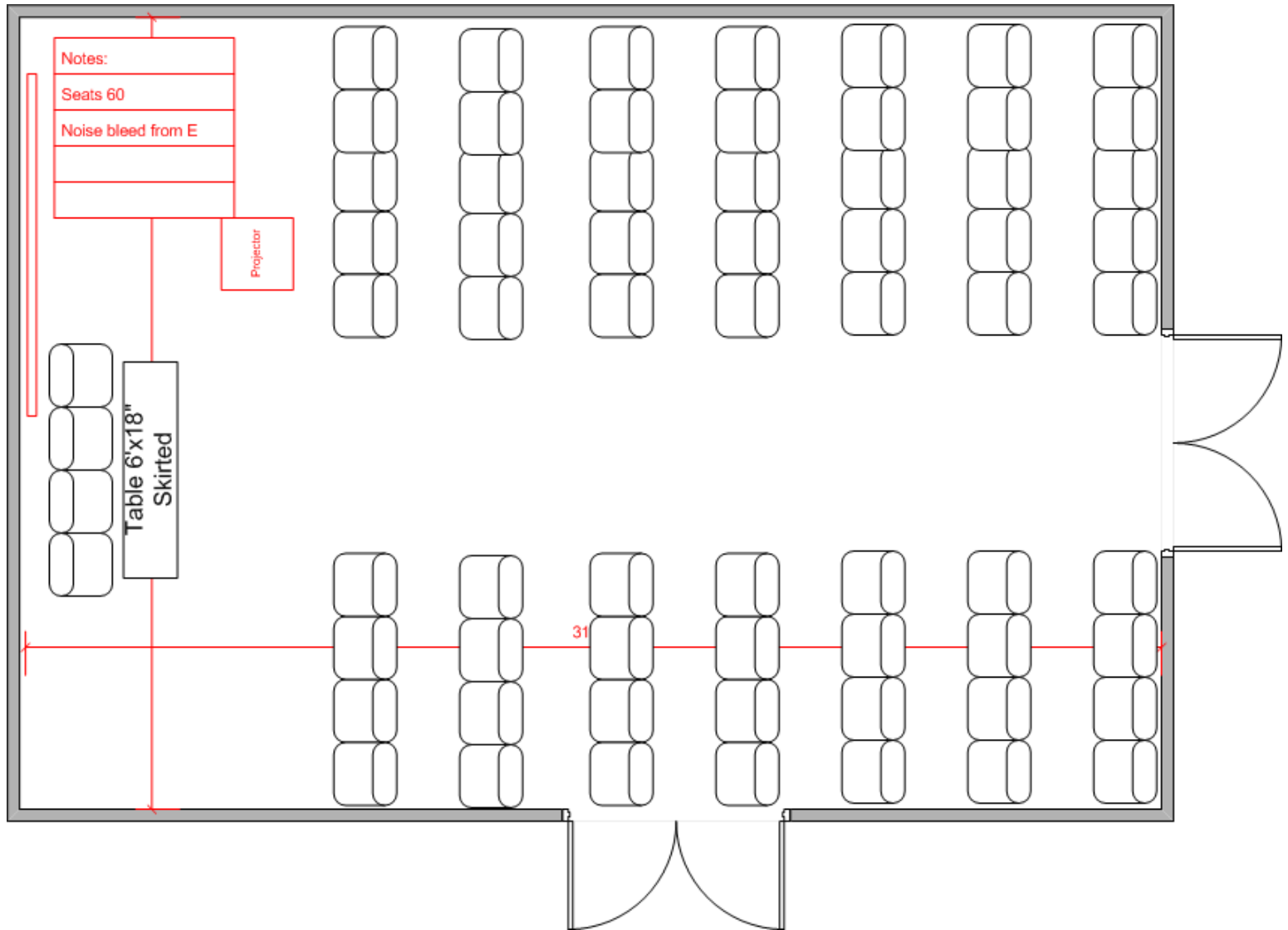

**Equipment:**

- 1 – Table (6' x 18")
- ~65 – Chairs
- 1 – Skirting

**Notes:**

Projector/Screen provided by Penguicon  
Door to main hallway should be locked.

**Room:** Boardroom

**Use:** Writer's Workshop(?)

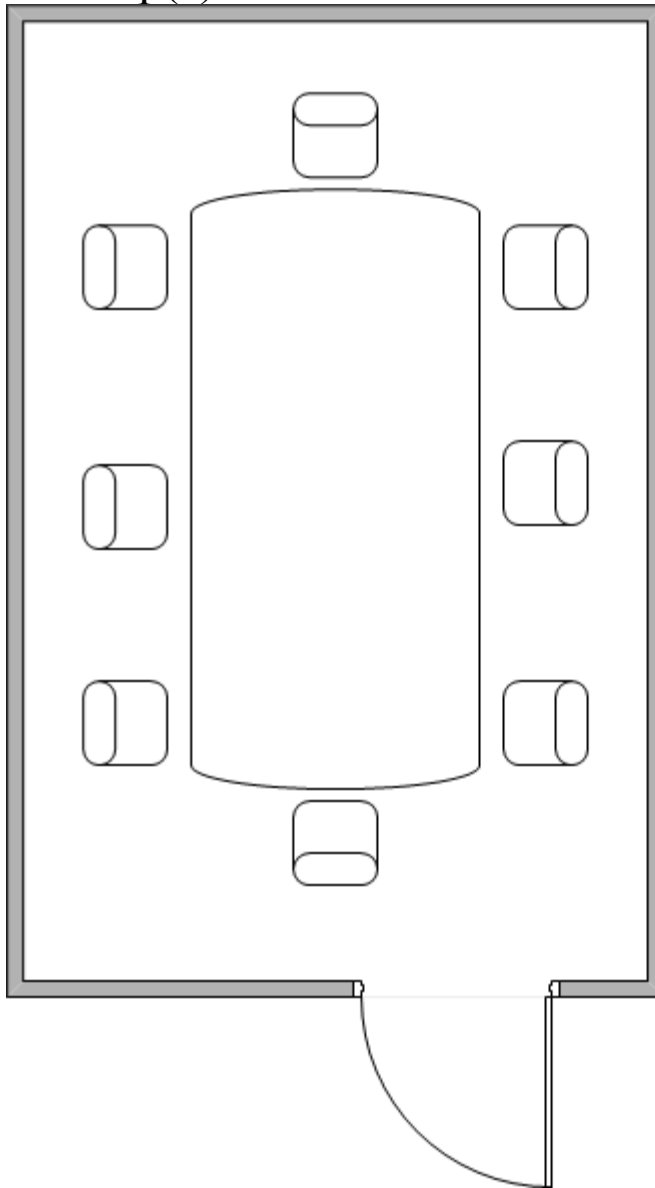

Notes:

**Equipment:**

None extra



**Room:** Lobby (Near the access ramp)

**Use:** Craft/Hobby Area

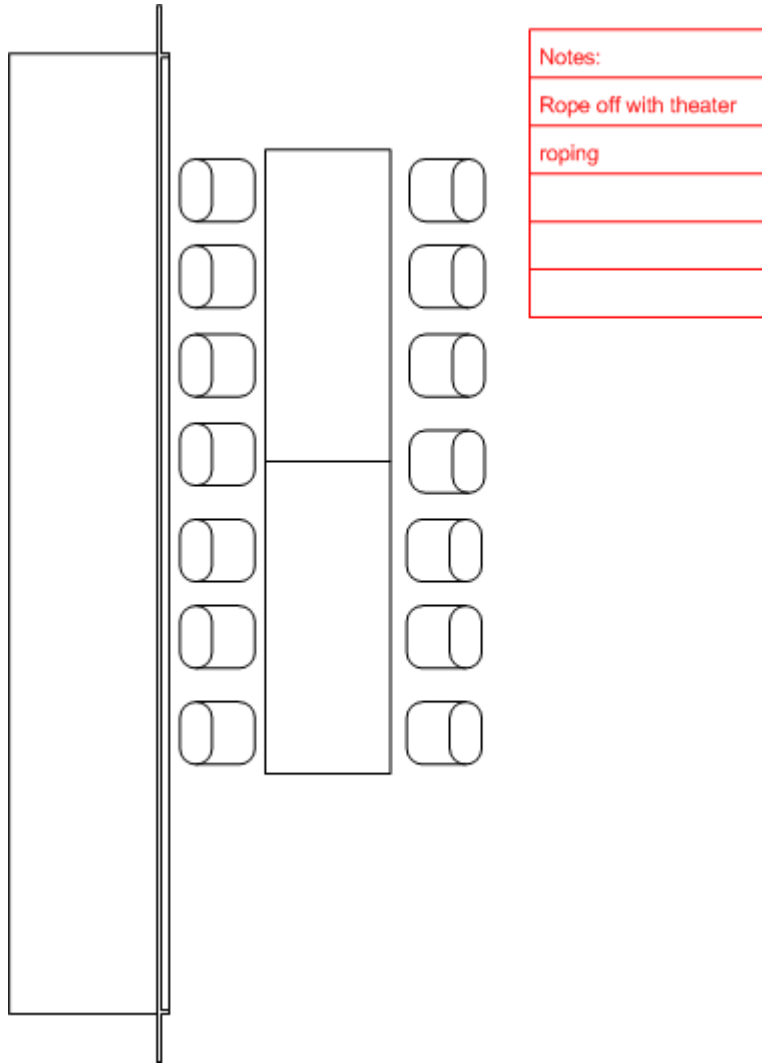

**Equipment:**

Nothing additional, so long as the long tables and stool-like chairs still exist when Penguicon occurs.

**Notes:**

This should be roped off with crowd control roping, if available.

**Room:** Dennison I  
**Use:** Medium Panels

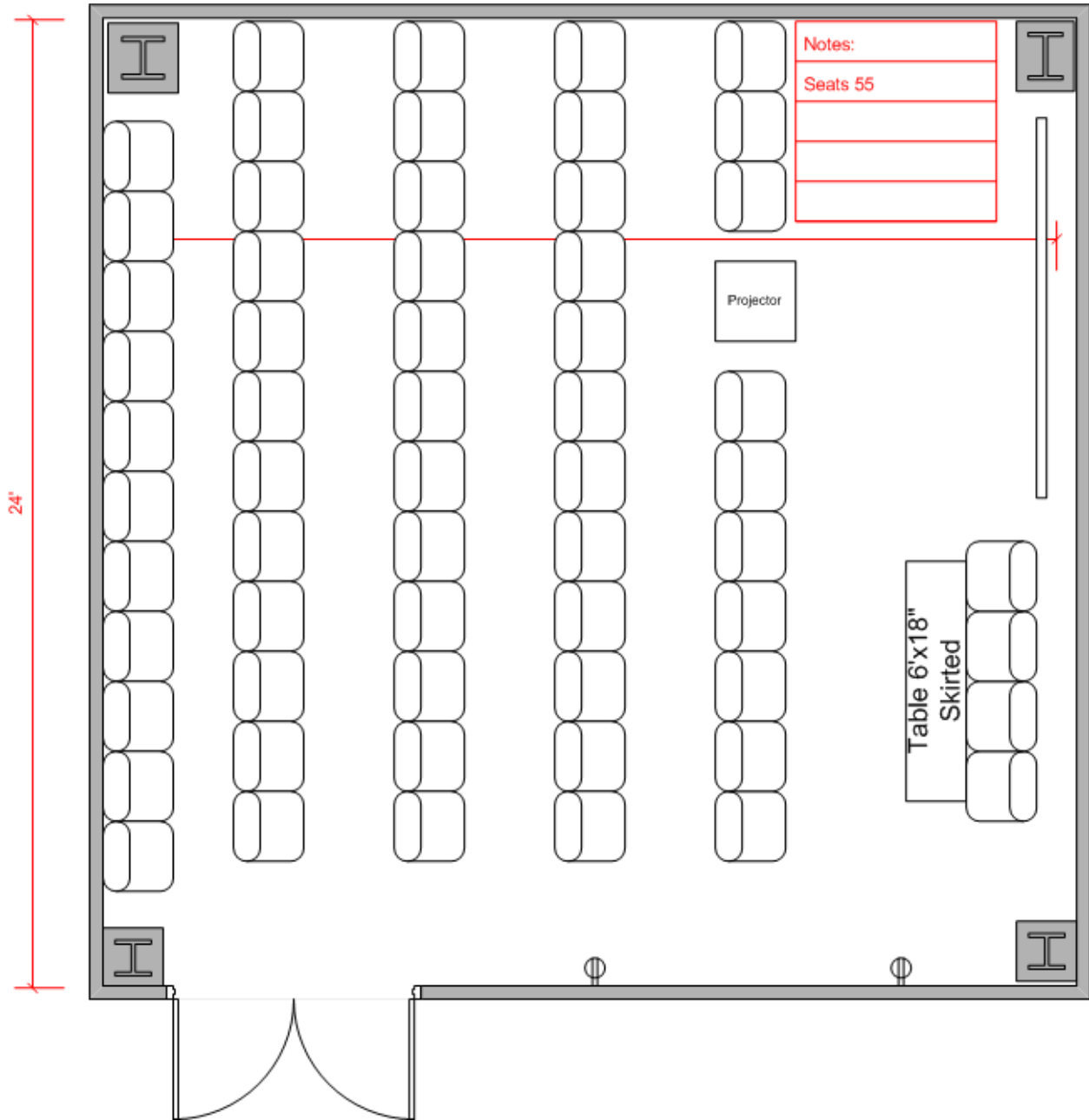

**Equipment:**

- 1 – Table (6' x 18")
- ~60 – Chairs
- 1 – Skirting

**Notes:**

Projectors and Screens provided by Penguicon

# Room: Dennisons II, III, & IV

## Use: Gaming

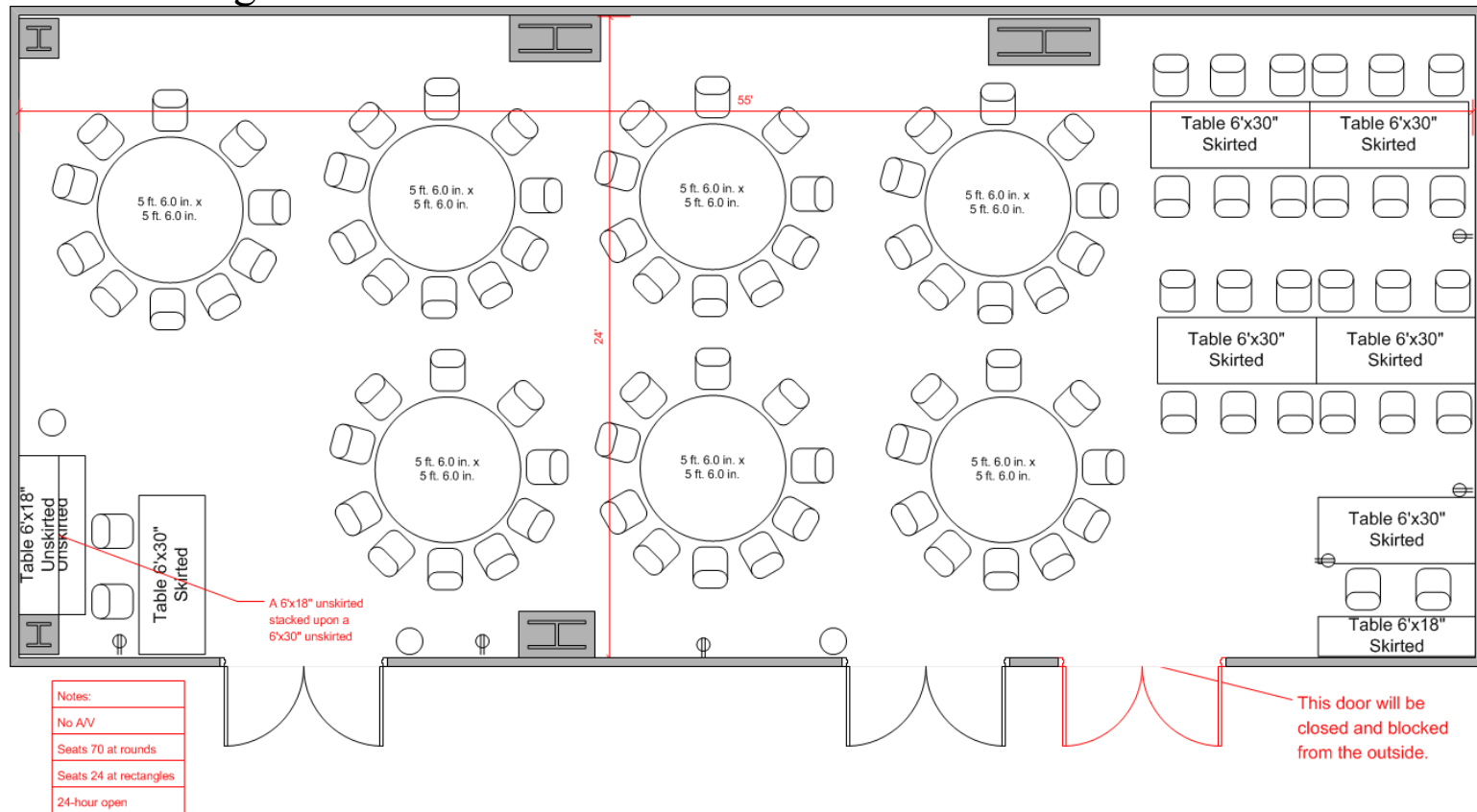

### Equipment:

- 7 – Tables (6'x30")
- 2 – Table (6'x18")
- 7 – Round (5' 6")
- ~98 – Chairs
- 7 – Skirting
- 7 – Round Skirting
- 3 – Large trash cans

### Notes:

- Open 24 hours
- Water service outside entrance
- Door nearest the end of the hall will be closed, locked, and blocked from the outside

**Room:** Dennison Hallway

**Use:** i3 Detroit Display

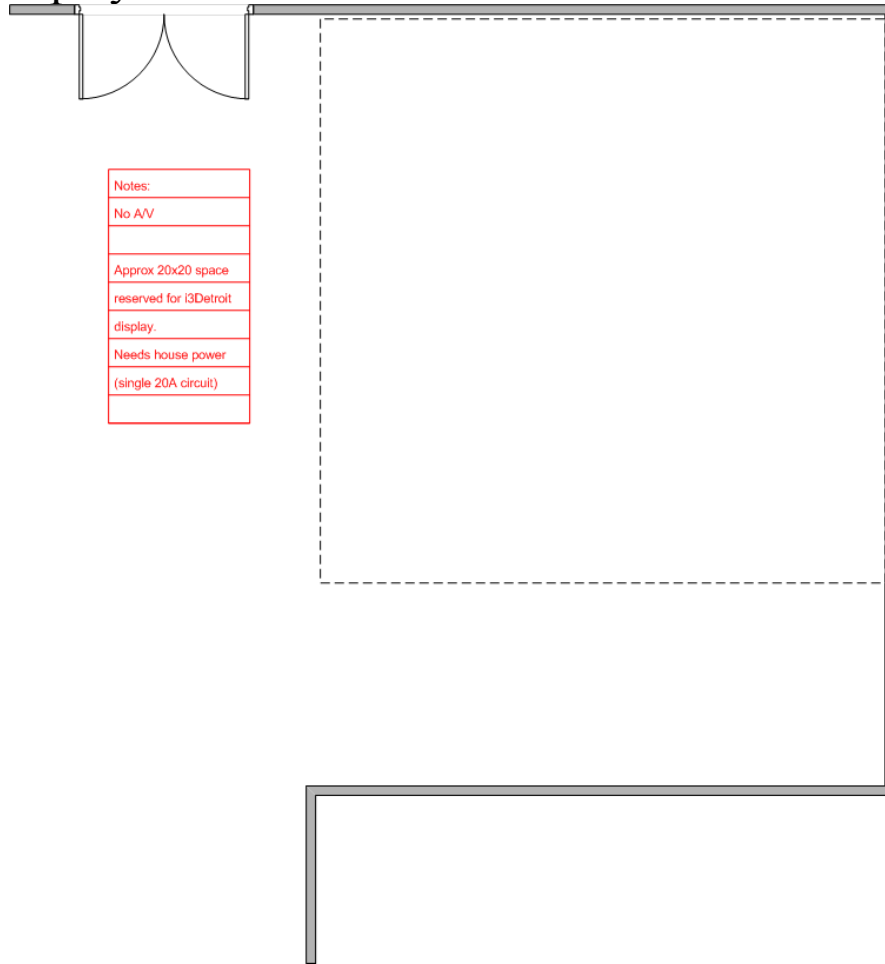

Notes:
No A/V
Approx 20x20 space reserved for i3Detroit display.
Needs house power (single 20A circuit)

**Notes:**

Area in box should be an approximately 20'x20' area left clear for i3Detroit displays.  
All furniture that remains should be relocated outside of the boxed area.  
The piano should be relocated at the end of the Ballroom A,B,C hallway.

# Room: Mediterranean

## Use: Dealer's Room / Artist's Alley

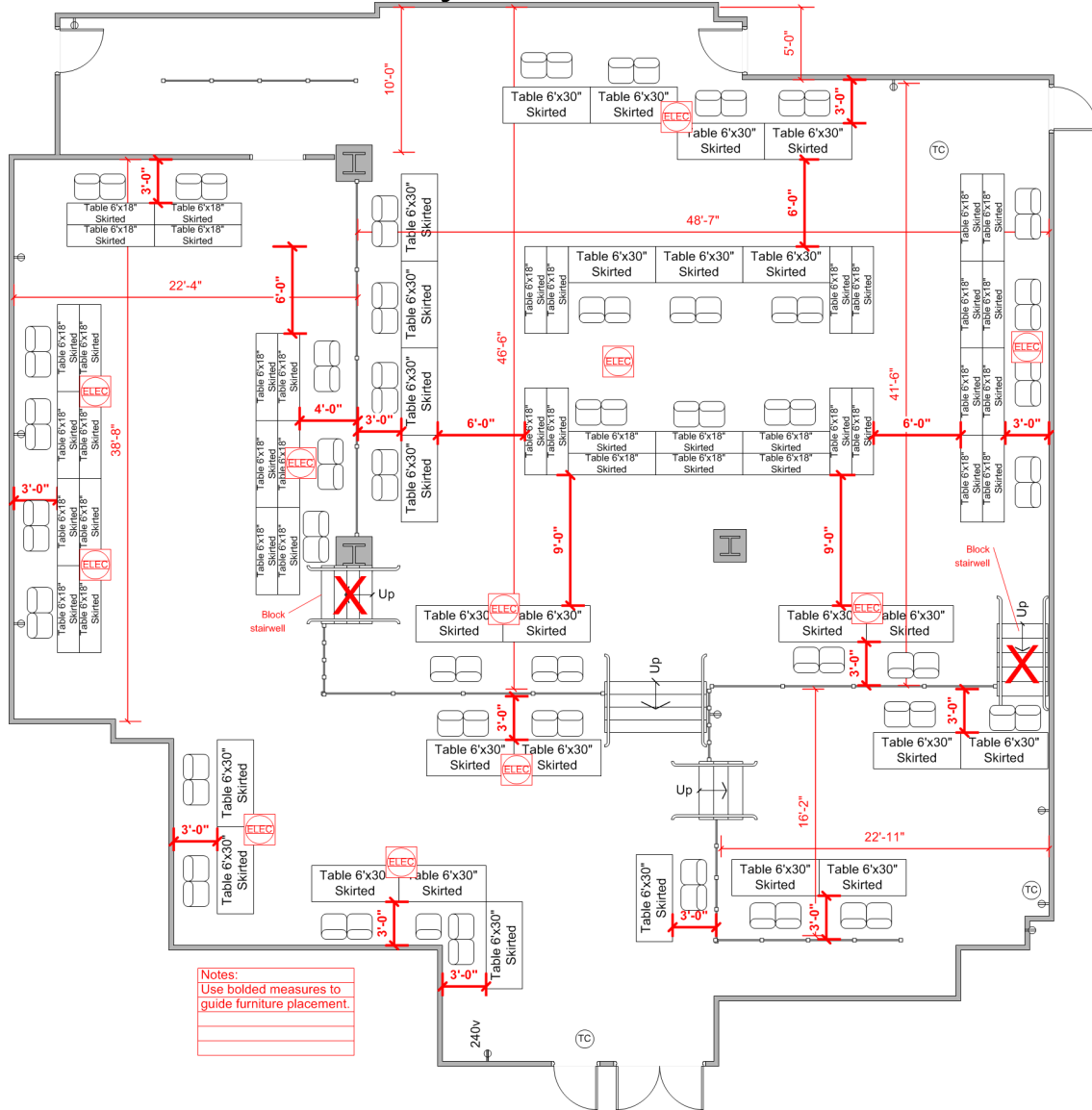

### Equipment:

- 27 – Tables (6' x 30")
- 40 – Tables (6' x 18")
- 87 – Chairs
- 2 – Roll-off beds
- 47 – Skirting
- 3 – Trash cans

### Notes:

Water service outside entrance

**Room:** Niles

**Use:** Music Programming

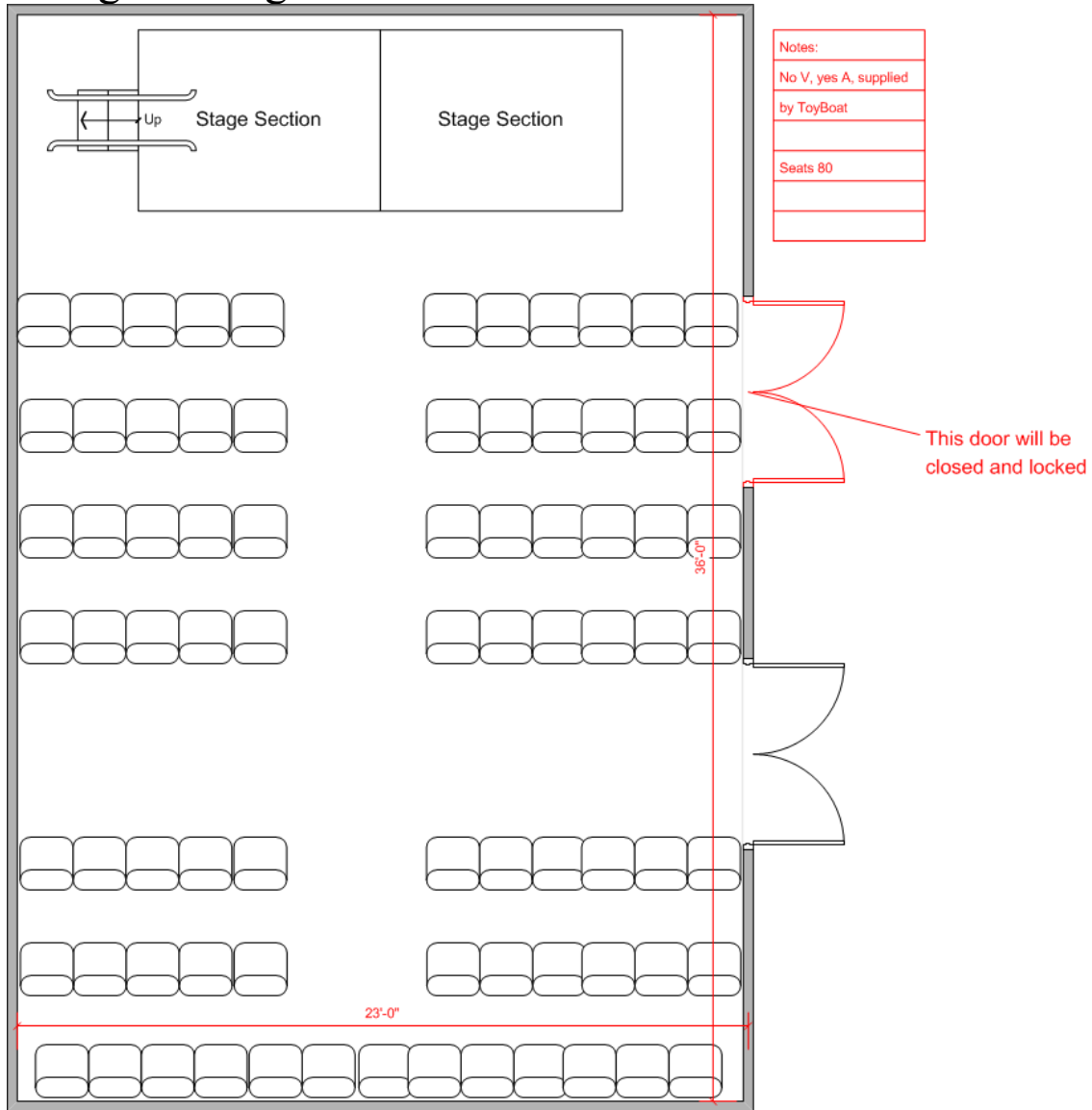

**Equipment:**

- ~80 – Chairs
- 2 – Stage sections
- 1 – Stage steps

**Notes:**

Audio panel provided by Penguicon  
 Water service outside door

**Room:** Room 1  
**Use:** Green Room

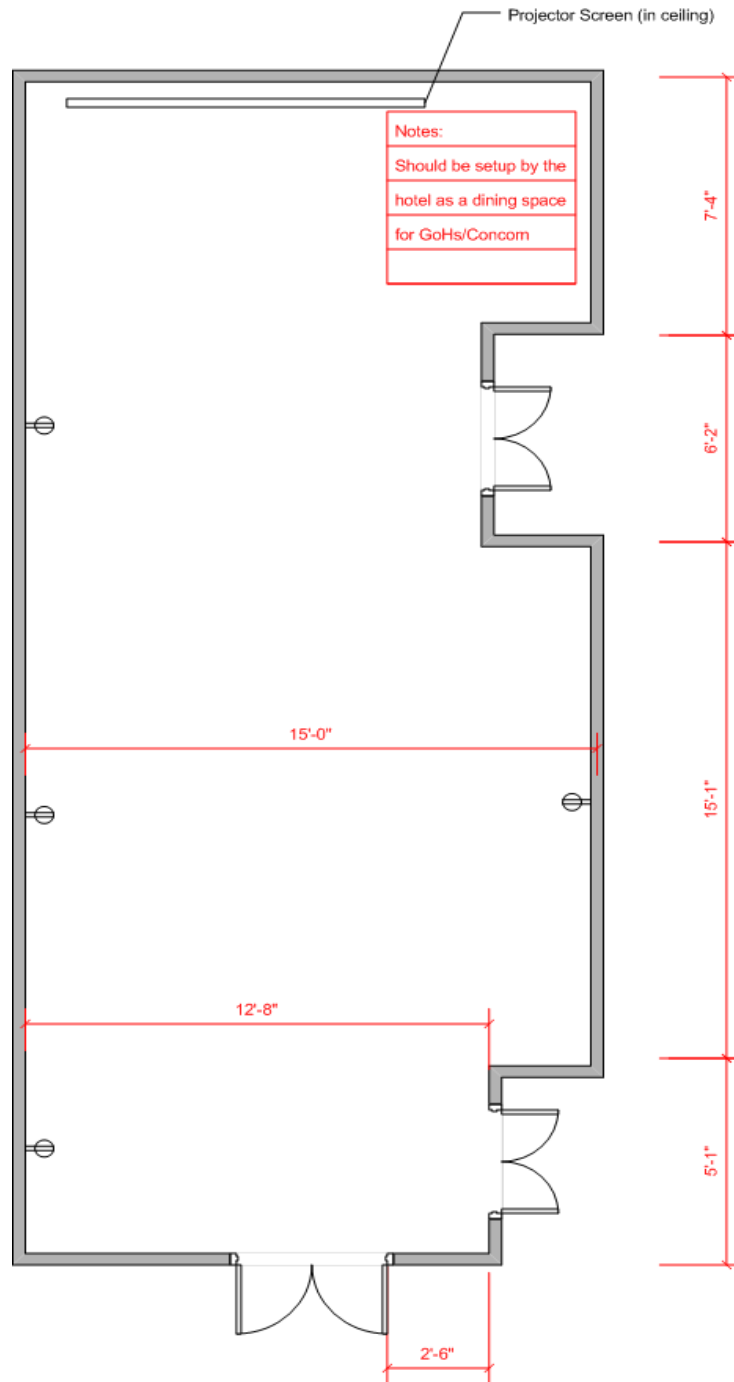

**Equipment:**

**Notes:**

Hotel will configure as a dining area for Guests of Honor

**Room:** Private Dining 1

**Use:** Small Panels

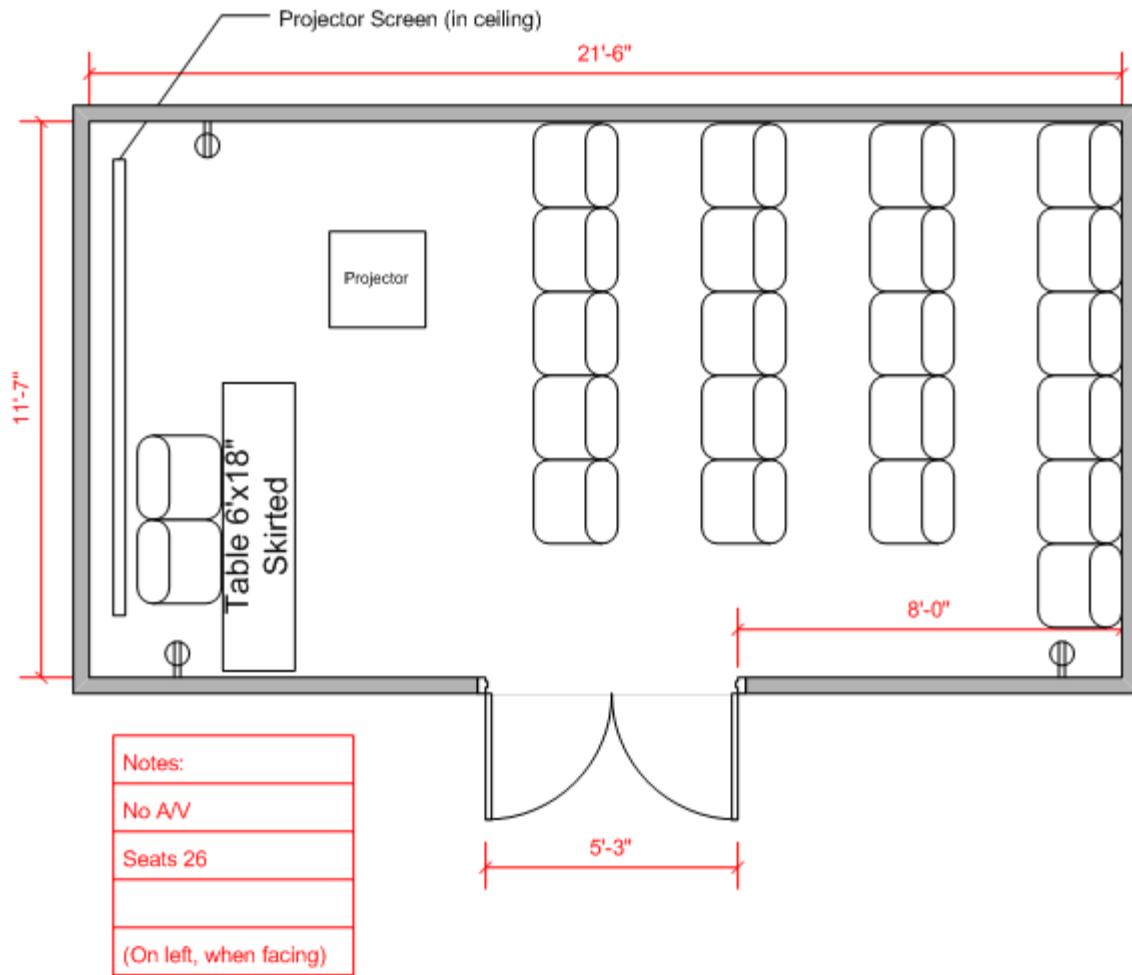

**Equipment:**

1 – Table (6'x18")

~23 – Chairs

1 – Skirting

**Notes:**

Projector provided by Penguicon. Screen is built into room



**Room:** Private Dining 2

**Use:** Small Panels

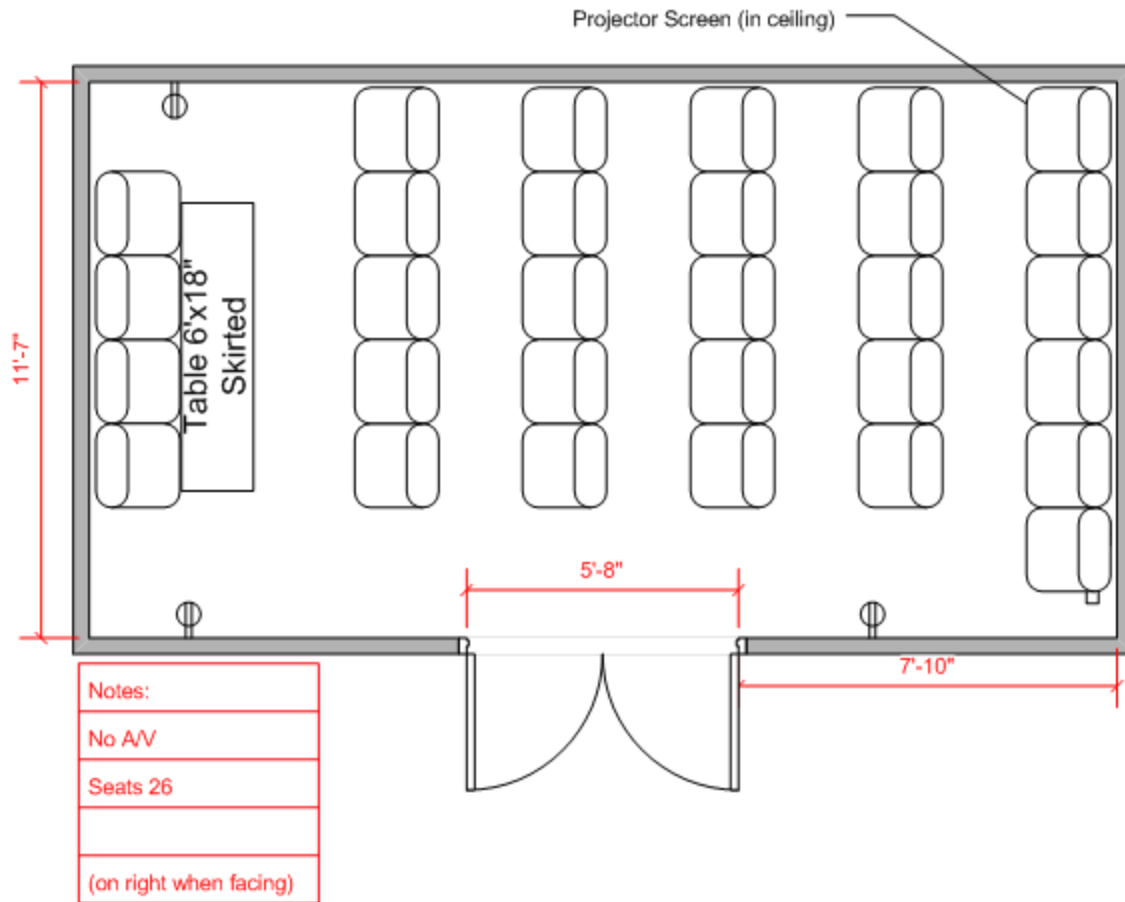

**Equipment:**

1 – Table (6'x18")

~30 – Chairs

1 – Skirting

**Notes:**

**Room:** Guest Room 1218

**Use:** Food Track Programming / LN2

**Equipment:**

1 – Table (6' x 30")

2 – Table (6' x 18")

4 – Chairs

3 – Skirting

**Notes:**

All beds and other removable furniture should be removed.

Tarps provided by Penguicon for protection of the carpet from food products

Pay services to room should be disabled

**Room:** Guest Room 1220

**Use:** Film / Anime Room

**Equipment:**

~25 – Chairs

**Notes:**

All beds and other removable furniture should be removed (TV/Armoire remains)

Chairs should be set in theater style, facing the television

Pay services to room should be disabled

**Room:** Guest Room 1222

**Use:** Eco Track

**Equipment:**

1 – Table (6' x 30")

~20 – Chairs

**Notes:**

All beds and other removable furniture should be removed.

Pay services to room should be disabled

Chairs should be left stacked in the room

**Room:** Guest Room 1709

**Use:** Penguicon TV

**Equipment:**

2 – Table (8' x 30")

~5 – Chairs

**Notes:**

Both beds should be removed.

Pay services to room should be disabled

Chairs should be left stacked in the room.

**Room:** Parking Garage

**Use:** First Robotics / Lego Robots

**Equipment:**

4 – Table (8' x 18")

~20 – Chairs

**Notes:**

Penguicon will supply tarps for this area for the Lego Robotics

Power needs to be supplied by the hotel (one or two outlets)

Area will be roped off by the hotel so that people can't park there